

目錄 MAPX	设变内容 MODIFICATION	日期 DATE

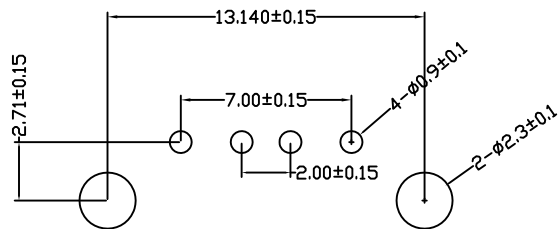
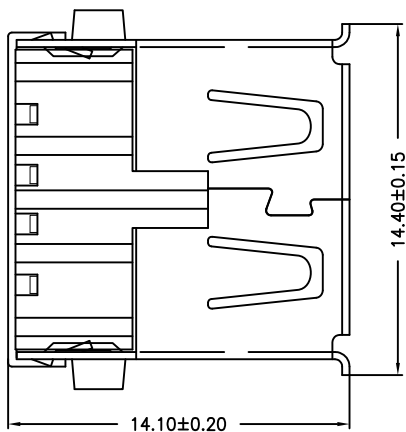
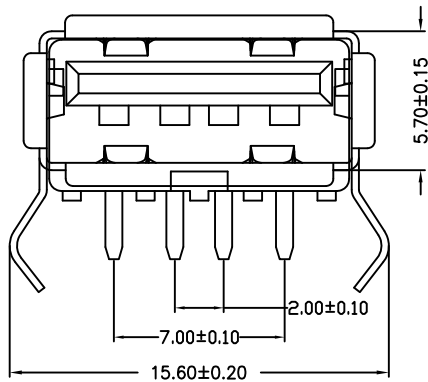
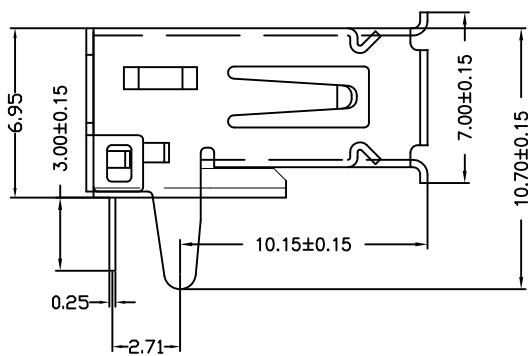

RBCOMMENDBD P.C.B PATTBRN LAYD UT

备注：侧弹分为外弹与内弹

NOTES:

Housing: Thermoplastics,UL94V-0  
 Contact: Copper Alloy  
 Shell: Copper Alloy/Steel  
 Voltage Current Rating:1.5 AMP. 30V AC  
 Insulation Resistance:1000MΩ Min.  
 Contact Resistance:30 MΩ Max.  
 Dielectric Withstanding Voltage:500W AC  
 Temperature Range:-35°C to +85°C  
 Insulator color: Black/White  
 Plastic material:PBT/LCP/Others  
 Shell finish:Nickel plated/Tin-Lead plated  
 Mechanical:  
 Mating Force:3.5KG MAX  
 Unmating Force:0.7 KG MIN.  
 Contact finish:

- 01: Selective Gold Flash
- 02: Selective Gold 3U"
- 03: Selective Gold 5U"
- 04: Selective Gold 15U"
- 05: Selective Gold 30U"

产品图 PRODUCT CHART DWG		易芯精密科技(浙江)有限公司 Easychips Precision Technology (Zhejiang) Co.,Ltd.			
公差一览表 TOLERANCE UNLESS OTHERWISE		单位 UNITS	制图 DRAWING	产品料号 PRODUCT PART NO.	A901-EC112A1011D10110
X.	±0.25	X'	±5'	产品名称 PRODUCT NO.	AF90度外扣弯脚有边内弹铜壳短弹 T型PBT白胶
.X	±0.20	.X'	±2'	日期 DATE	2009/10/20
.XX	±0.15	.XX'	±1'	核准 APPD	角法 VIEW
.XXX	±0.10	.XXX'	±0.5'	版本 VER	A0