

MAPX	MODIFICATION	DATE

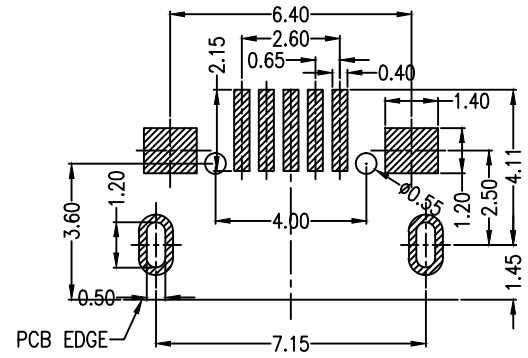
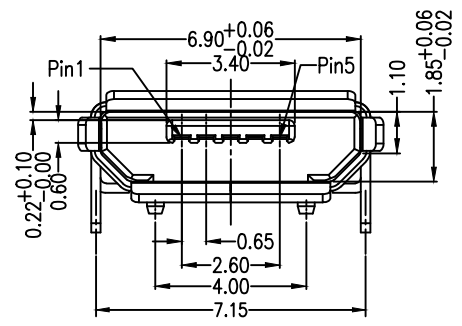
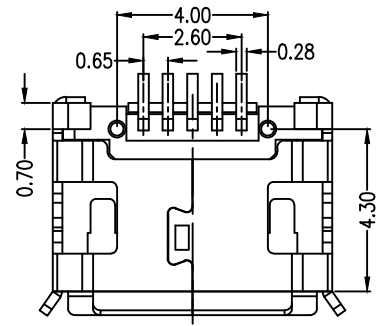
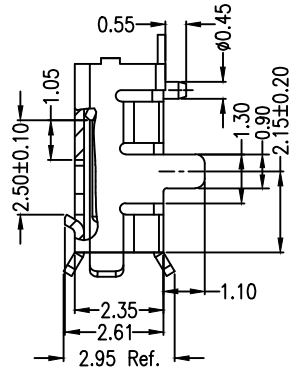
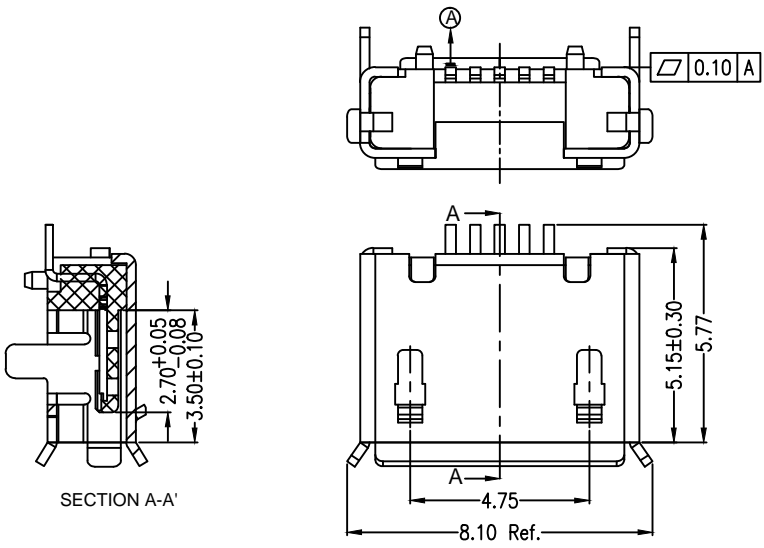

RECOMMENDED PCB LAYOUT
PCB图仅供参考

- Note:
- Material:
 - Housing: High temperature thermoplastic with g.f,UL94v-0
 - Contact: copper alloy,t=0.20mm
 - Shell: copper alloy,t=0.25mm
 - Specification:
 - Current rating:1,5PIN 1.8A Max/2,3,4PIN 1A Max.
 - Dielectric withstanding voltage: 100 V(ac) for 1 min.
 - Contact resistance: 30 mΩ Max.
 - Insulation resistance: 100 MΩ Min.
 - Total mating force: 3.57 Kgf Max.
 - Total unmating force: 1.0 Kgf Min.
 - Temperature range: -30°C~80°C

产品图 PRODUCT CHART DWG		易芯精密科技(浙江)有限公司 Easychips Precision Technology (Zhejiang) Co.,Ltd.					
公差一览表 TOLERANCE UNLESS OTHERWISE		单位	MM	制图	制图料号	PRODUCT PART NO.	B920-ECA52A2021S10103
X.	±0.30	X.	±5.°	比例	1:1	审核	产品名称
.X	±0.25	.X	±2.°	SCALE	1:1	核	MICRO 5P-F B型两脚DIP7.2有边脚
.XX	±0.20	.XX	±1.°	日期	2019.11.23	角法	长1.1有柱加焊脚加长0.75SMT
.XXX	±0.10	.XXX	±0.5°	DATE	2019.11.23	角法	版本
				APPD		VIEW	VER
							AO