

MAPX	MODIFICATION	DATE

Note:
 1.Material:
 1.1 Housing: High temperature thermoplastic with g.f,UL94v-0
 1.2 Contact: copper alloy,t=0.15mm
 1.3 Shell: copper alloy,t=0.30mm
 2.Specification:
 2.1 Current rating:1,5PIN 1.8A Max/2,3,4PIN 1A Max.
 2.2 Dielectric withstanding voltage: 100 V(ac) for 1 min.
 2.3 Contact resistance: 30 mΩ Max.
 2.4 Insulation resistance: 100 MΩ Min.
 2.5 Total mating force: 3.57 Kgf Max.
 2.6 Total unmating force: 1.0 Kgf Min.
 2.7 Temperature range: -30°C~80°C

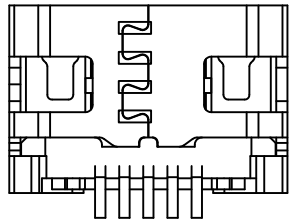

不锈钢双铆合

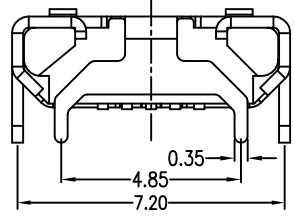
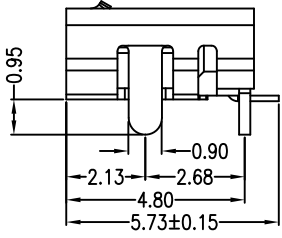
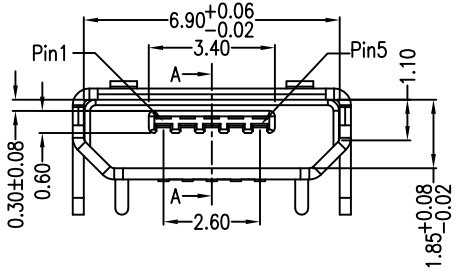
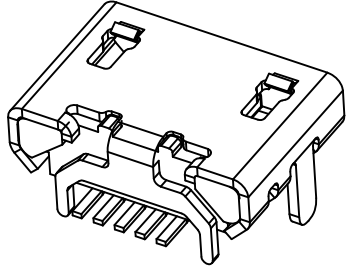
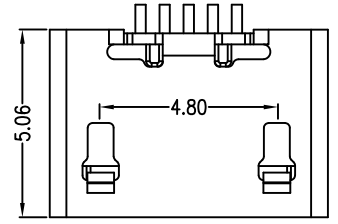
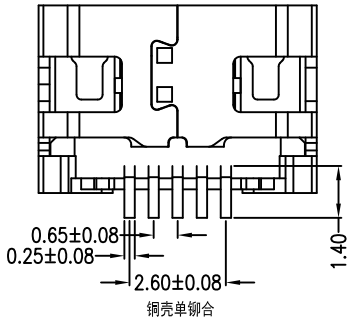

铜壳单铆合

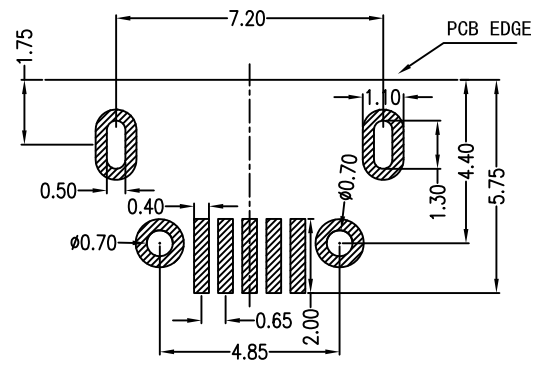

PCB图仅做参考

产品图 PRODUCT CHART DWG				易芯精密科技(浙江)有限公司 Easychips Precision Technology (Zhejiang) Co., Ltd.			
公差一览表 TOLERANCE UNLESS OTHERWISE				单位	MM	制图	制图料号
X.	±0.30	X.	±5.°	UNITS		DRAWING	PRODUCT PART NO. B920-ECE62A2021S10101
.X	±0.25	.X	±2.°	比例	1:1	审核	产品名称
.XX	±0.15	.XX	±1.°	SCALE		核	无柱SMT端子加长0.75黑胶
.XXX	±0.10	.XXX	±0.5°	日期	2021-04-16	准	角法
				DATE		APPD	VIEW
							版本
							VER
							AO