

| | | |
|------|--------------|------|
| MAPX | MODIFICATION | DATE |
|------|--------------|------|

Note:

1.Material:

- 1.1 Housing: High temperature thermoplastic with g.f,UL94v-0
- 1.2 Contact: copper alloy,t=0.15mm
- 1.3 Shell: copper or sus304,t=0.25mm

2.Specification:

- 2.1 Current rating:1,5PIN 1.8A Max/2,3,4PIN 1A Max.
- 2.2 Dielectric withstanding voltage: 100 V(ac) for 1 min.
- 2.3 Contact resistance: 30 mΩ Max.
- 2.4 Insulation resistance: 100 MΩ Min.
- 2.5 Total mating force: 3.57 Kgf Max.
- 2.6 Total unmating force: 1.0 Kgf Min.
- 2.7 Temperature range: -30°C~80°C

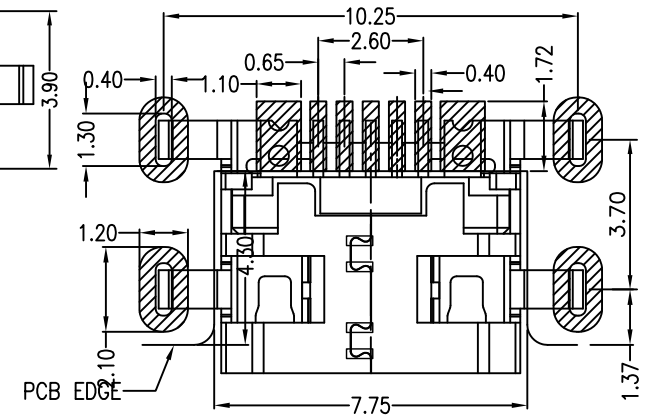
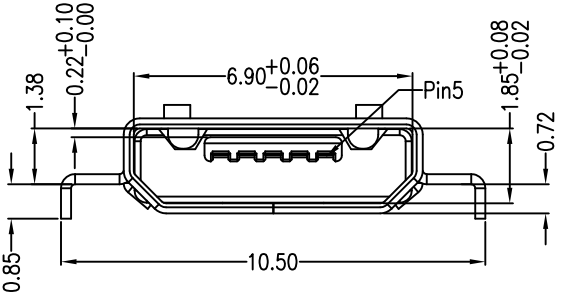
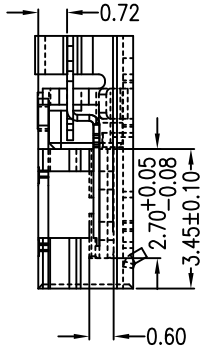
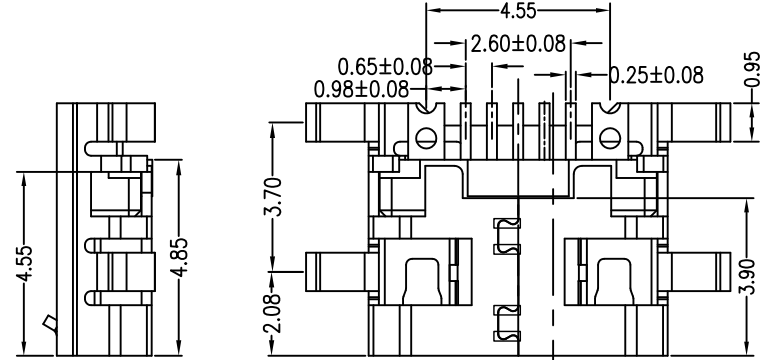
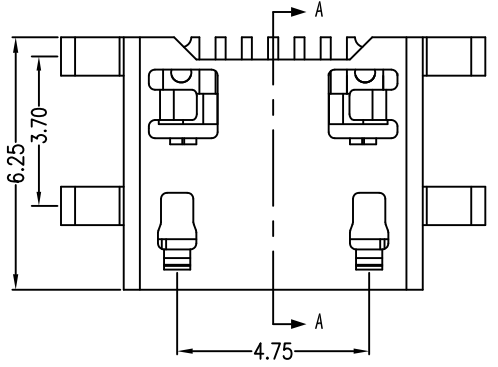
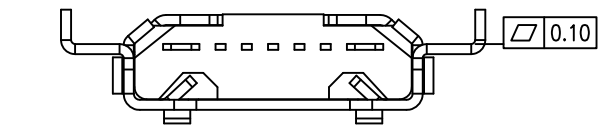

RECOMMENDED PCB LAYOUT

PCB图仅供参考

SEC A-A

| | | | | | | | | | |
|--|-------|------|-------|---|------------|---------------|--------------------------|--------------------------|----|
| <p>产品图 PRODUCT CHART DWG</p> <p>公差一览表 TOLERANCE UNLESS OTHERWISE</p> | | | | <p>易芯精密科技(浙江)有限公司 Easychips Precision Technology (Zhejiang) Co., Ltd.</p> | | | | | |
| X. | ±0.35 | X. | ±5° | 单位 UNITS | MM | 制图 DRAWING | 制图料号 PRODUCT PART NO. | B920-ECF62A2021S10103 | |
| .X | ±0.30 | .X | ±2° | 比例 SCALE | 1:1 | 审核 CHKD | 产品名称 PRODUCT NO. | MICRO/5F 沉板式0.7四脚插板无边有接地 | |
| .XX | ±0.20 | .XX | ±1° | 日期 DATE | 2015-09-09 | 核准 APPD | 角法 VIEW | 版本 VER | AD |
| .XXX | ±0.10 | .XXX | ±0.5° | | | | | | |