

REV	ECN No.	DESCRIPTION	DESIGN	DATE
A	-	NEW RELEASE		2018.01.08

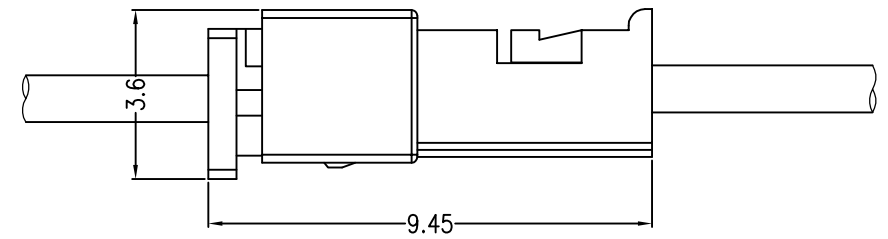
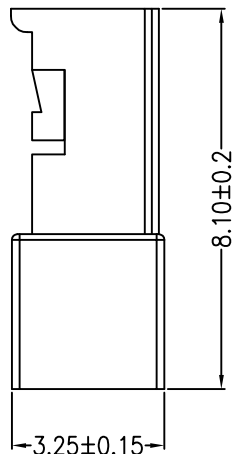
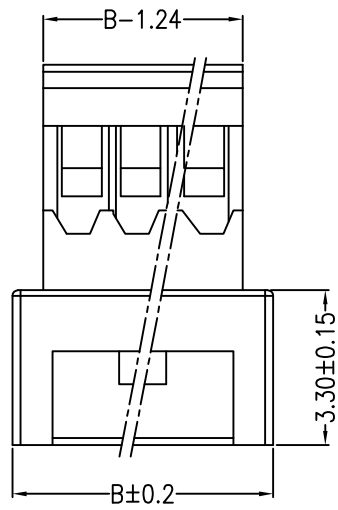

Assembly Layout

主要技术参数 Main Specifications

线 数 (Poles): 02 to 16
 接触电阻 (Contact resistance): $\leq 20m\Omega$
 绝缘电阻 (Insulation resistance): $\geq 100M\Omega$
 额定电压 (Rated voltage): 125 V AC DC
 额定电流 (Rated current): 1.0A AC DC
 耐 电 压 (Withstand Voltage): 500V AC/minute
 温度范围 (Temperature Range): $-25^{\circ}C \sim +105^{\circ}C$

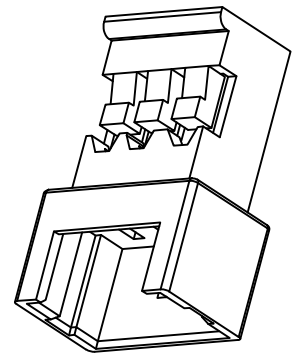
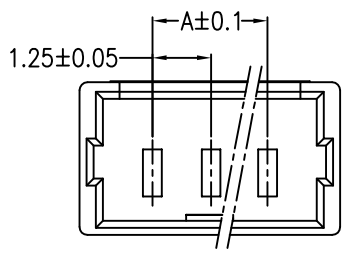

Circuits	Dimensions (mm)	
	A	B
02	1.25	4.20
03	2.50	5.45
04	3.75	6.70
05	5.00	7.95
06	6.25	9.20
07	7.50	10.45
08	8.75	11.70
09	10.00	12.95
10	11.25	14.20
11	12.50	15.45
12	13.75	16.70
13	15.00	17.95
14	16.25	19.20
15	17.50	20.45
16	18.75	21.70

C					
B					
A	HOUSING		1~16 PCS	PA66	COLOR:WHITE
ITEM	COMPONENT		Q'TY	MATERIAL	FINISH

			TITLE: C1251R 1.25mmPITCH Housing	
			PART NO.: EC-C-125802**-WW-A-R	
USE: CUSTOMER APPD: CHKD:			DWG NO.:	
UNITS: mm 			SCALE 1 : 1	SHEET 1 / 1