

P.C.B LAYOUT

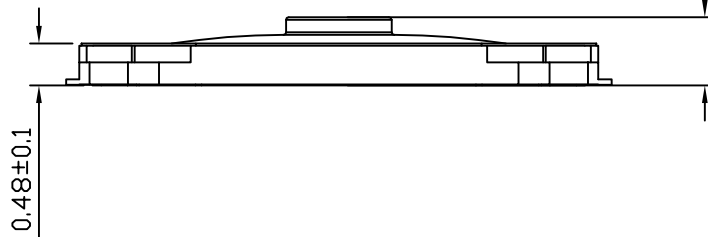

SPECIFICATIONS:

Operating temperature range: -30°C to +85°C
 Rating: Max 50 mA 12V DC Min 10 μ A 1V DC
 Insulation resistance: 100M Ω min. 100V DC
 Dielectric strength: 100V. AC. 1Min
 Contact resistance: 100m Ω Max
 Life: 1,000,000 Cycles
 Travel: 0.25 \pm 0.05mm
 Operating force: 250 \pm 30gf

TOLERANCE				DESIGN	DATE	TITLE	Tact Switch	
UNLESS OTHERWISE STATED				WYJ	2024. 04. 08			
X.X	\pm 0.20	SIZE	A4	CHKD	DATE	MODEL	ECTAF18-N-C	
X.XX	\pm 0.15	REV	A	APPD	DATE	SHEET	1/3	
X.XXX	\pm 0.10	UNIT	mm			PRINT DATE	2024.05.17	
\angle	\pm 2°	SCALE	12:1					